

TECHNICAL DATA

REVERSIBLE VIBRATORY PLATES

BPR 70/70 D, BPR 100/80 D



Maximum longevity

Full protection hood - engine and components protected all around



Safe and dead easy to operate

BOMAG fingertip control



Higher quality, lower costs

ECONOMIZER - The compaction display (optional)

Shipping dimensions in m3

BPR 70/70 D 1,133
BPR 100/80 D 1,376

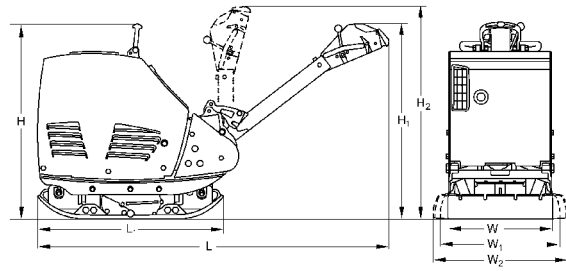

Standard Equipment

- Engine protection hood
- Electric starter
- Tip-Control
- Back-up drive protection
- Low vibration steering rod
- Height adjustable steering rod
- Steering rod lockable in transport and working position
- Vibration and throttle regulation on the steering rod
- Highly wear-resistant, powder-coated base plate
- Automatic shutdown at low oil level
- Multi-functional, foldable single-point lifting facility
- Extension plates (700mm) (BPR70/70D)
- Extension plates (800mm) (BPR100/80D)
- 3-2-1 Warranty
- Hour meter

Optional Equipment

- ECONOMIZER (+5kg)
- Tool kit
- Special painting
- Plastic mat
- Extension plates (850mm) (BPR70/70D)
- Extension plates (950mm) (BPR100/80D)
- Service Kit
- Environmentally compliant hydraulic oil
- Safety crank-handle for emergency starting (+3kg)
- US Version EPA 4 NRTC (BPR70/70D:9,2kW) (BPR100/80D:10,1kW)
- TOUGH WARRANTY

Dimensions in mm

	H	H1	H2	L	L1	W	W1	W2
BPR 70/70 D	870	1030	1470	1860	980	550	700	850
BPR 100/80 D	910	1080	1470	1890	980	650	800	950

Technical Data

Technical Data	BOMAG		
	BPR 70/70 D	BPR 100/80 D	
Weights			
Operating weight CECE (W)	kg	557	687
Operating weight CECE (W1)	kg	580	710
Operating weight CECE (W2)	kg	595	726
Basic weight	kg	570	705
Dimensions			
Basic working width	mm	700	800
Working width without extension bars (W)	mm	550	650
Lowest passing height	mm	870	910
Min. height w. steering in top position	mm	1.030	1.080
Max. height w. steering in top position	mm	1.180	1.180
Driving Characteristics			
Working speed, max.	m/min	28	28
Max. gradeability (dep. on soil con.)	%	35	35
Drive			
Engine manufacturer		Hatz	Hatz
Type		1D 81	1D 90
Emission stage		non EPA	non EPA
Cooling		air	air
Number of cylinders		1	1
Performance ISO 3046	kW	9,3	10,3
Speed	min-1	2.700	2.600
Drive system		mech. diesel	mech. diesel
Fuel		2,0	2,2
Fuel comsump. aver. during operation	l/h		
Exciter system			
Frequency	Hz	66	56
Centrifugal force	kN	70	100
Amplitude	mm	1,80	2,70
Capacities			
Fuel	l	10,0	10,0

Technical modifications reserved. Machines may be shown with options.



PRE 692 64 010

130217 Sa01

BOMAG
 Hellerwald
 D-56154 Boppard
 P.O. Box 5162
 Tel. (0)6742 - 1000
 Fax (0)6742 - 3090

